

Step 1. Make right position and screw hole on the ceiling, screw the clip on the ceiling tightly.

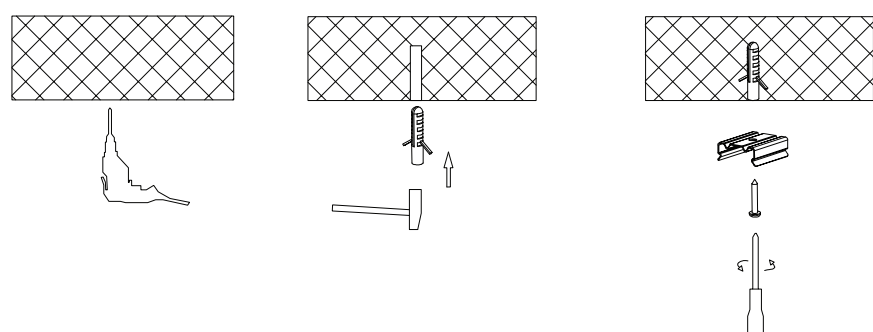

Step 2. Snap the lamp into clips.

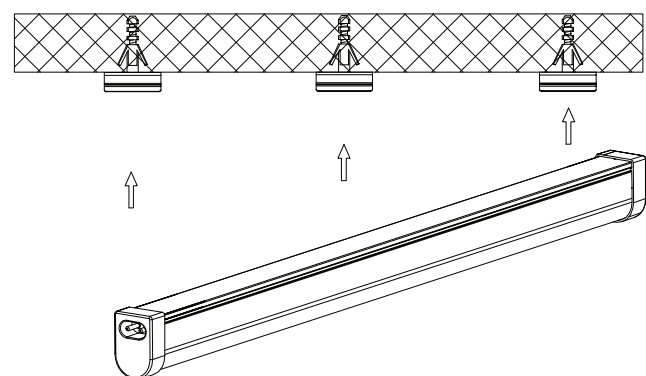

IMPORTANT NOTES FOR INSTALLATION!!

1. When using the magnets the surface of installation must be 100% flat, without obstructions and must have magnetic surface (over the full surface)
2. At the beginning and end of the tube, magnets must be placed as close as possible (against plastic endcap)
3. The left magnets must be equally divided over the rest of the tube
4. When there is no flat surface or no magnetic underground for installation, remove magnets from clips and use screws to install

For electrical installation, see installation manual

Step 3. Connect lamps as below figure, insert the power connector to first lamp, and fix end cap on male connector of last lamp. The installation finished.

